

EB44 **EB60**



**EB** EASTBAY

**EB60**



## CONTENTS

Our Ethos	3
The Eastbay Legacy	4
Design	5
V-Warp® Technology	6
The power of three	7
Customization	8
Ease of operation	11
Ease of maintenance	12
Build journey	13
Techs and specs	15
Layouts	17
Gallery	18



#### OUR ETHOS

## A LEGEND REBORN!

We're on a mission!

All of us here at the GB Marine Group are dedicated to restoring the Eastbay brand to its former glory.

In doing so, we're mindful of the trailblazing history that we are entrusted to protect. Back in 1993, the EB38 was launched at the Miami Boat Show and single-handedly created the 'Downeaster' category.

It quickly became synonymous with speed, style and comfort - widely emulated yet never surpassed.

But while times may have changed, our values and standards have not.

We are committed to using the most contemporary materials, production techniques and design solutions to ensure that the new Eastbay range authentically retains its proud heritage while re-establishing its primacy within the world of recreational cruisers.

It's been an exciting challenge and we're more than proud of what we have achieved.

Mark Richards,  
CEO and Designer



EB49 SX IN THE SAN JUANS

#### THE EASTBAY LEGACY

## 'CLASSIC' MEANS THEN, NOW AND FOREVER

When the EB38 was unveiled at the Miami Boat Show in 1993, it single-handedly created the 'Downeaster' category of luxury motor yachts.

Fast, luxurious, spacious and beautifully styled, the instant demand for the brand led to the development of a series of models over the following years.

1995 saw the arrival of the EB40 which then became the EB43. In 1997 the EB49 was the star performer in Miami where 31 were sold at the show!

In 2001 the EB58 was launched and became the largest of the fleet.

The enduring appeal of these boats has conferred the status of 'Modern Classic' on the Eastbay range and the sheer volume of enquiries we receive has led us to recommit to its future and ensure that the next generation of models will carry this heritage forward with pride.



## DESIGN

# THEN MEETS NOW!

At our 50,000 square meters, fully-covered production facility, we've achieved the perfect combination of state-of-the-art technology and traditional hand craftsmanship.

Our 24-man design team is dedicated to evolving our standards of luxury, elegance and utility while pushing the envelope of what is possible in terms of performance, stability and efficiency.

The EB60 retains the unique character and style of the early models while taking full advantage of next generation technology.



V-WARP® TECHNOLOGY

## A SYNERGY OF HULL DESIGN, EXOTIC MATERIALS AND BUILD PHILOSOPHY

The EB60 is built on our proprietary V-Warp® Technology.

Designed by our team of leading naval architects, the underwater geometry of our hull form was informed by the NASA and American Navy databases and then further developed by our CEO's experience as an ocean racing champion.

The warped, semi-displacement form reduces drag while adding the buoyancy, stability and lift that allows the boat to reach plane speed with minimal energy and effort.

Our extensive use of carbon fibre dramatically reduces weight, while our construction techniques maintain extreme rigidity. It's this combination that enables V-Warp® technology to deliver class-leading speed and stability while using only half the fuel of a similar sized boat.

**V-WARP TECHNOLOGY**  
MAKES PERFECT SENSE OF  
THE ADAGE, "LESS IS MORE!"

LESS FUEL, **MORE RANGE**  
LESS POWER, **MORE SPEED**  
LESS WEIGHT, **MORE STABILITY**



Our combination of Vinylester-infused e-glass in the hull and carbon fibre in the deck and superstructure increases strength and durability while reducing weight.

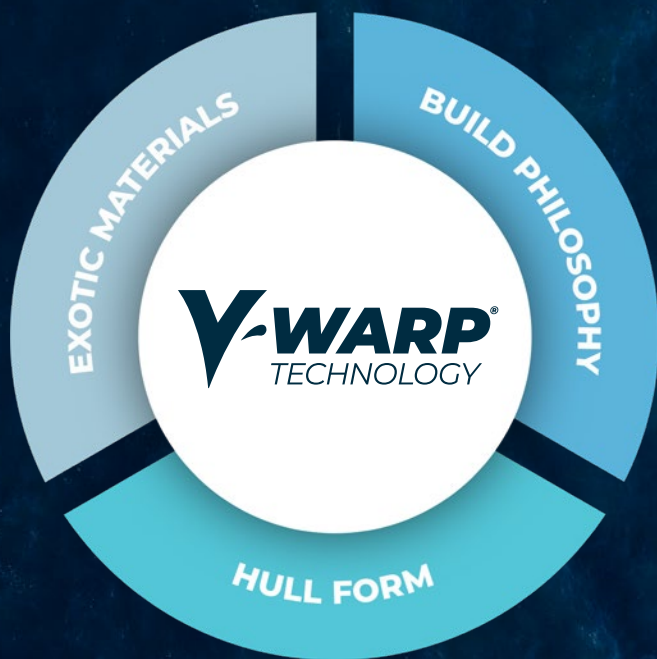

Designed by ocean-racing champion Mark Richards and his team of naval architects, the hull design was informed by data from NASA and the US Navy. It delivers a low running attitude that reduces resistance and delivers a smooth, soft ride.

All bulkheads and fixed furniture are fused to the hull. This 'torsion box' rigidity won't flex or creak. Large mass components are positioned to ensure longitudinal and transversal equilibrium.

THE POWER OF THREE

# PERFORMANCE, HANDLING AND EFFICIENCY

There's no one reason that ensures the EB60 achieves such extraordinary performance characteristics. There are three!

It's the synergy of our hull form, our use of exotic materials and our build philosophy that delivers our speed, characteristically soft ride, ease of handling and extraordinary fuel efficiency.

## CUSTOMIZATION

# IT'S NOT ANY EASTBAY, IT'S YOUR EASTBAY.

Every model is made to order. Quite simply, this means that we don't commence construction until we are 100% sure that the yacht we are going to build has been designed to meet your specific requirements in terms of style and practicality.

There is a great deal to consider - engine and drive train, stateroom and galley configurations, internal and external color, fixtures and fittings, fabrics and upholstery.

Our design team will give expert and personal advice throughout the process.





CUSTOMIZATION

## AMBIENCE AND STYLE

You'll be able to choose from a wide range of fabrics and upholstery, fixtures, fittings and finishes to create the mood and setting that will best suit your onboard lifestyle.

Our inhouse team can work with you directly. Or you can ask them to liaise with an independent interior designer that you know and like.



CUSTOMIZATION

# CHOICE OF HULL COLORS

Your choice of hull and boot stripe colors will have an indelible effect on the style and appearance of your boat. You can experiment with various combinations using the configurator on the 'Build a boat' page of our website. Of course, we also offer custom colors from a broader palette.



[CLICK HERE FOR OUR ONLINE CONFIGURATOR](#)

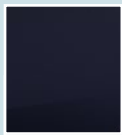

Flag Blue

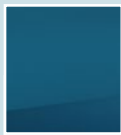

Horizon Blue



Metallic Blue



Flag Blue



Horizon Blue



Metallic Blue



# COVE LINES AND BOOT STRIPES

These subtle details can create a very stylish effect in combination with your choice of hull color.

Gold cove line with red boot stripe



Red cove line with white boot stripe



Red cove line with white boot stripe



Red cove line with red boot stripe



EASE OF OPERATION

## FINGERTIP CONTROL

It was Einstein who said, 'Everything should be as simple as possible, but no simpler.' He could well have been talking about our design philosophy!

At the helm station, you'll find the control interface inspires that reassuring feeling of everything being in the right place and within easy reach.

The combination of joystick controls and uninterrupted sight lines takes the stress out of navigating crowded marinas or mooring in tight slips.

We're ever mindful that this is a 'pleasure craft' and we keep workload to a minimum.



## EASE OF MAINTENANCE

# KEEPING EVERYTHING SHIP SHAPE

Accessed via a teak hatch in the cockpit, the EB60's engine room is a study in orderliness, simplicity and practicality.

There's no spiderweb of wires, hoses and cables and no complicated fuel manifold. All components have been carefully placed and color-coded where necessary to make them easy to identify and access.

The neat and precise layout of the engine room ensures easy and comfortable access for inspections and maintenance.



## THE BUILD JOURNEY

# YOU'LL BE WITH US EVERY STEP OF THE WAY

When the design has met your approval and before construction begins, you'll be invited to come and spend some time with us at our factory.

Whether you choose to do this at the start or in the middle of the build, you'll find this to be a fascinating opportunity to understand the process your boat will follow as it leaves the mold and then snakes through the factory from one specialist team to the next.

You will, of course, receive regular and constant updates and reports of the boat's progress and our schedule allows for any suggestions and comments you'd like to make as the boat takes shape.



**ESCAPE INTO THE MOMENT.  
MANY MOMENTS.**





## VITAL STATISTICS

### TECHNICAL SPECS

Length Overall	68' 1"	20.74 M
Length On Deck	60' 10"	18.55 M
Beam	19'	5.8 M
Air Draft	16' 11"	5.14 M
Draft IPS	3' 9"	1.14 M
Draft Shafts	4' 1"	1.24 M
Displacement	59,500 LBS	27,000 KG

### CAPACITY

Fuel Capacity	1,519 GAL	5,750 L
Water Capacity	300 GAL	1,100 L
Holding Tank	80 GAL	300 L

### STANDARD ENGINES

Volvo Penta IPS 950s @ 725 HP		
Draft	3' 9"	1.14 M
Top Speed	30 KNOTS	
Cruise Speed	25 KNOTS	
Range	844 NM / 38 GPH / 21 KN	

### OPTIONAL ENGINES

Volvo Penta IPS 1350s @ 1,000 HP		
Draft	3' 9"	1.14 M
Top Speed	38 KNOTS	
Cruise Speed	30 KNOTS	
Range	906 NM / 34 GPH / 20 KN	

All figures provided are for the standard configuration of the vessel, recorded at half-load at the time of testing. Different test conditions and customizations from the standard model may result in variations for your yacht.

## LAYOUTS

# FLEXIBLE SPACE

With the choice of an up or down galley, the broad beam of the EB60 creates ample space for up to three or four luxurious staterooms with two large heads. This will provide luxurious, overnight accommodation for up to six adults.

Huge electric windows ensure the salon is bright and airy and our wide beam ensures you will have plenty of room for entertaining the family and friends who may join you onboard.

This classic design style provides everything you need and nothing you don't. Beauty without ostentation!





# LAYOUTS

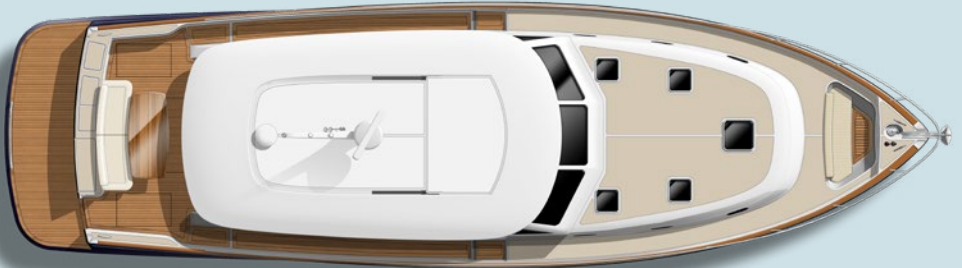

EB60 SEDAN WITH LOWER GALLEY

EB60 SEDAN WITH UPPER GALLEY

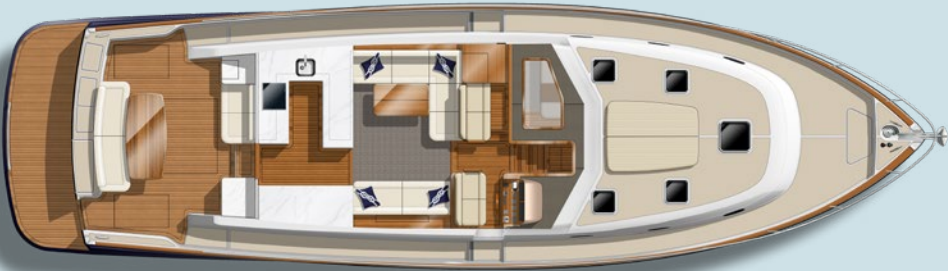

# OUR STORY TOLD IN PICTURES



# GALLERY



# GALLERY



# GALLERY



# GALLERY



**FOR ANY ENQUIRIES,  
PLEASE CONTACT YOUR NEAREST  
EASTBAY REPRESENTATIVE**

US HEAD OFFICE  
TEL: +1 877 2914220

AUSTRALIAN HEAD OFFICE  
TEL: +61 2 9979 5601

OR REACH OUT TO US THROUGH  
[EASTBAYYACHTS.COM](http://EASTBAYYACHTS.COM)

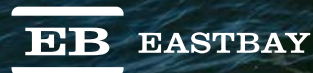

PROUD TO BE PART OF THE  
**GB** MARINE  
GROUP