

## THE GB85. A GLIMPSE OF THE FUTURE, A NOD TO THE PAST.

This vision of beauty and perfection is a computer-rendered illustration of the yacht that will soon rewrite the rules of long-distance cruising.

Behold the Grand Banks 85.

The GB85 is not just a bigger Grand Banks. It's a whole new class of boat.

Technically, at just over 87 feet, the 85 has inched into the 'Superyacht' category. But as well as breaking this class barrier, our exquisite new vessel is set to break every record for performance, efficiency and range in any category you care to mention.



### TECHNICAL SPECS

Length Overall	87' 2"	26.58 M
Length On Deck	78' 9"	24 M
Beam	22' 2"	6.75 M
Air Draft	25' 9"	7.8 M
Draft IPS	4' 11"	1.5 M
Draft Shafts	4' 1"	1.25 M
Displacement	108,000 LBS	49,000 KG

### CAPACITY

Fuel Capacity	2,640 GAL	10,000 L
Water Capacity	370 GAL	1,400 L
Holding Tank	(400 BLACK, 600 GREY)	1,000 L

### STANDARD ENGINES

2 x Volvo IPS 1350s @ 1,000 HP		
Draft	4' 11"	1.5 M
Cruise Speed	20 KNOTS	
Range (est.)	1,000 NM / 20 KN 3,000 NM / 10 KN	

### ENGINE CHOICES

2 x Man V8 V-drives @ 1,300 HP

**GB85 FLYBRIDGE**



## GB85 SKYLOUNGE

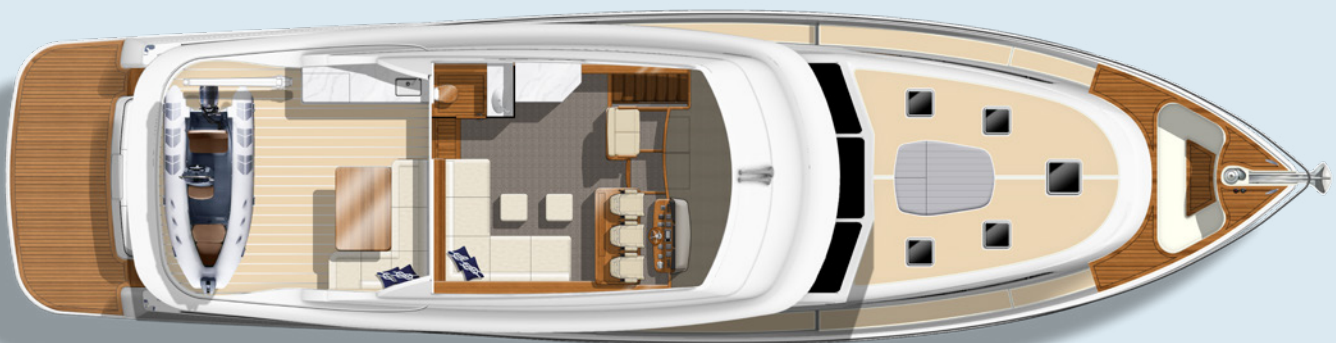



## GB85 SKYLOUNGE WITH TRIPLE SINGLES

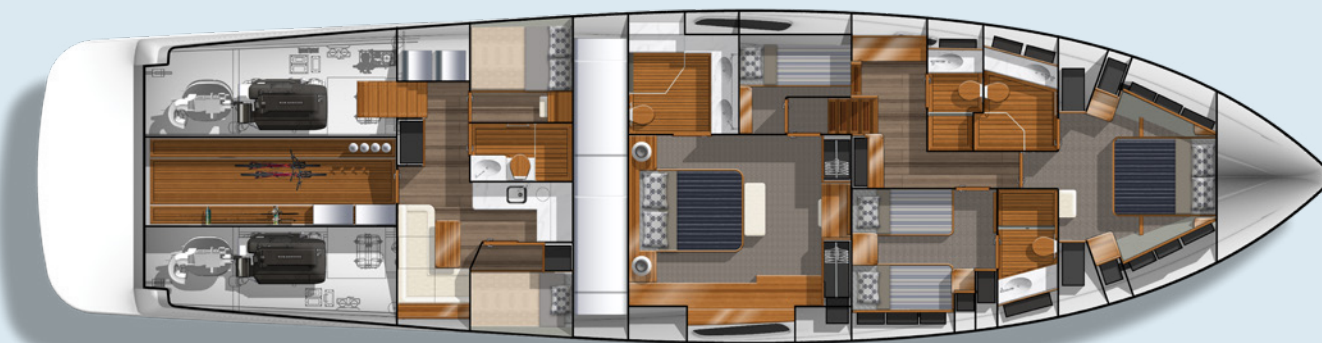

## GB85 GRAVING PLANS

